



Brickdale House, Swingate, Stevenage, SG1 1AS

Geoffrey Matthew Property Management are delighted to offer for let this MODERN TWO BED APARTMENT WITH BALCONY situated within Stevenage New Town and only a short walk from the mainline station offering links to Kings Cross & St Pancras (approx. 20 mins). Stevenage New Town offers high street stores including Tesco Supermarket, and also being a 10-minute walk from Stevenage Old Town which offers an array of bars, coffee bars and restaurants. Internally the properties benefit from modern open plan kitchen/lounge integrated white goods, good-sized DOUBLE bedroom and a single bedroom, modern and spacious bathroom.

Building has secure intercom entry, lift to all floors.

Holding Deposit equivalent to one weeks rent payable to apply for this property.

£1,350 Per Calendar Month

Brickdale House, Swingate, Stevenage, SG1 1AS



- MODERN APARTMENT
- Lift Service
- Modern Bathroom Suite
- Large Selection Of Local Shops
- Two Bedroom
- Fitted Kitchen With Integrated Appliances
- Balcony
- Town Centre Location
- Gas Central Heating
- Short Walk To Station

Hallway

With entry phone system, a quality dark wood effect laminate flooring, a large storage cupboard also housing heating system and doors to all rooms.

Open plan lounge/kitchen

18'4"x 9'5" (5.59x 2.87)

A modern open plan living space comprising of a good range of contemporary Antique cream high gloss wall and base units square edged butcher block wood effect work tops with inset single bowl stainless steel sink and drainer with mixer taps over, electric halogen hob with stainless steel

chimney style cooker hood and stainless steel electric oven, integrated under counter fridge, dishwasher and washing machine, inset lighting, single panel radiator, a continuation of the quality wood effect laminate flooring, double glazed windows and double glazed door to the balcony.

Bedroom 1:

13'4"x 9'4" (4.06x 2.84)

With double glazed window and single panel radiator.

Bedroom 2:

9'9"x 7'5" (2.97x 2.26)

With double glazed window and single panel radiator.

Bathroom

6'8"x 5'10" (2.03x 1.78)

Fitted with a modern three piece bathroom suite comprising of a panel surround bath with chrome mixer taps and shower attachment, glass shower screen, a large square shaped hand wash basin with chrome mono-bloc mixer tap and WC both enclosed within a dark wood effect vanity unit, mainly ceramic tiled walls, ceramic tiled flooring, a heated towel rail, wall mounted mirrored vanity unit with shaving light.

Communal entrance hall

With secure entry phone system and lift service and personal mail boxes.



Directions



Floor Plan

Ground Floor

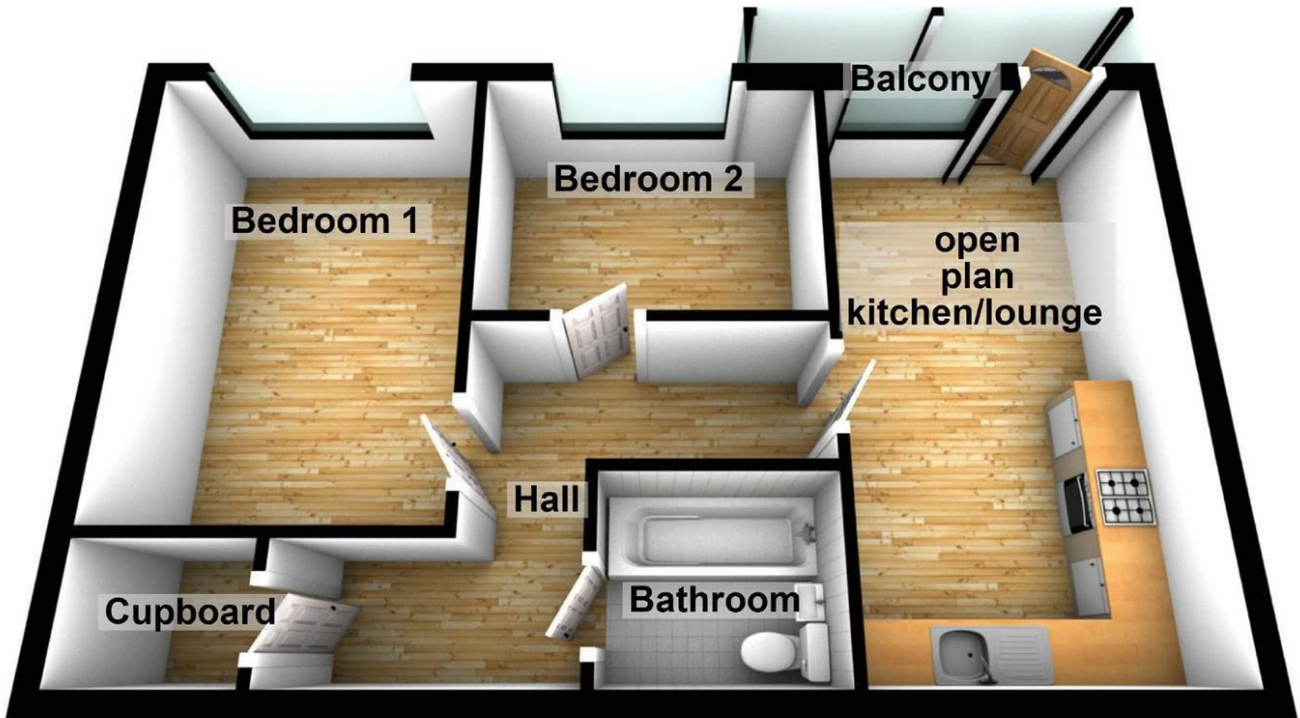

Council Tax Details

Stevenage Band

These particulars, whilst believed to be accurate are set out as a general outline only for guidance and do not constitute any part of an offer or contract. Intending purchasers should not rely on them as statements of representation of fact, but must satisfy themselves by inspection or otherwise as to their accuracy. No person in this firm's employment has the authority to make or give any representation or warranty in respect of the property.

